

11.1

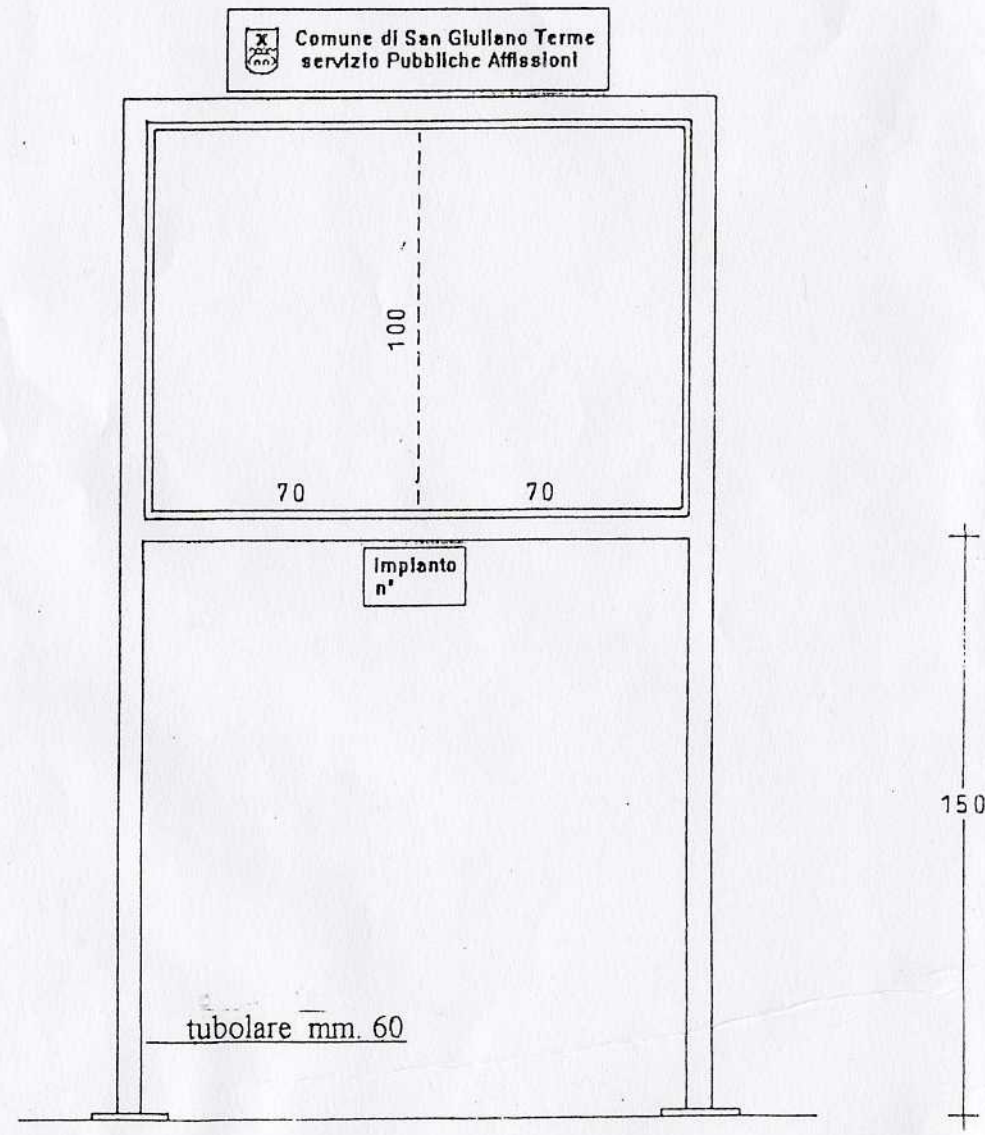

"standardo tipo A"

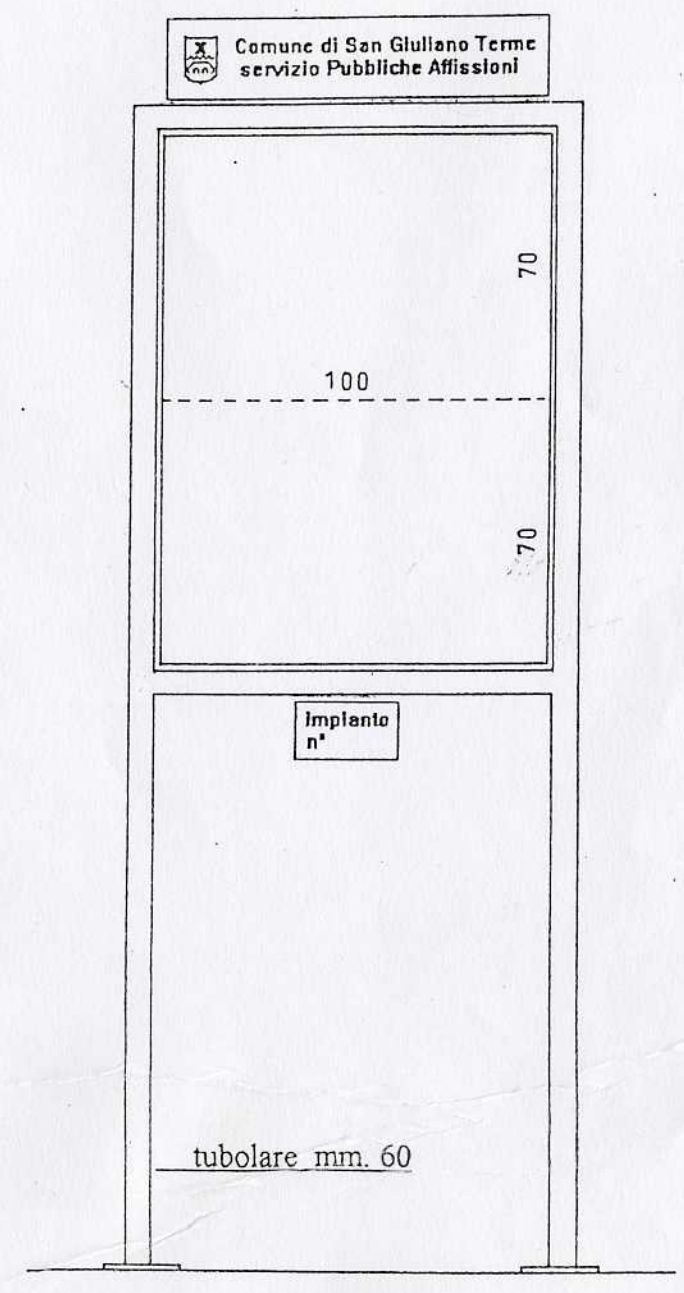

"standardo tipo B"

11. 00

Comune di San Giuliano Terme
servizio Pubbliche Affissioni

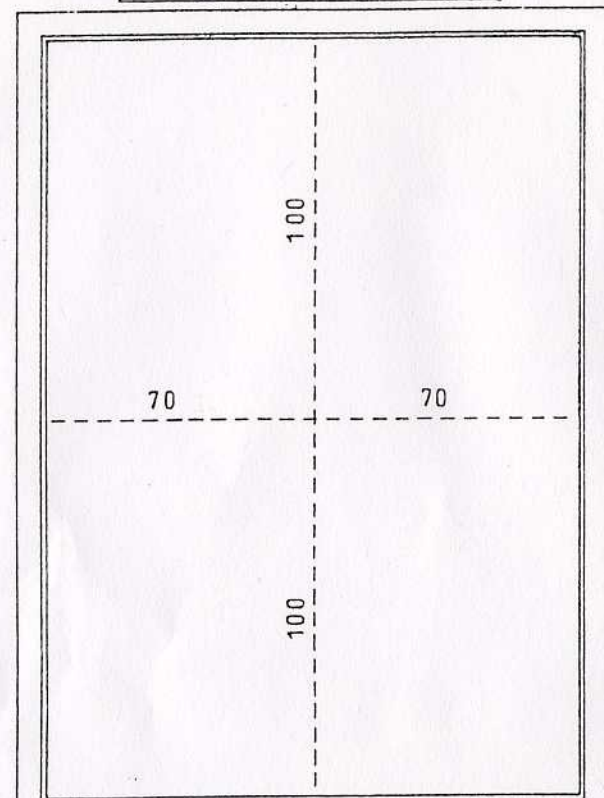

Impianto
n°

tubolare mm. 60

150

"standardo tipo C"

Comune di San Giuliano Terme
servizio Pubbliche Affissioni

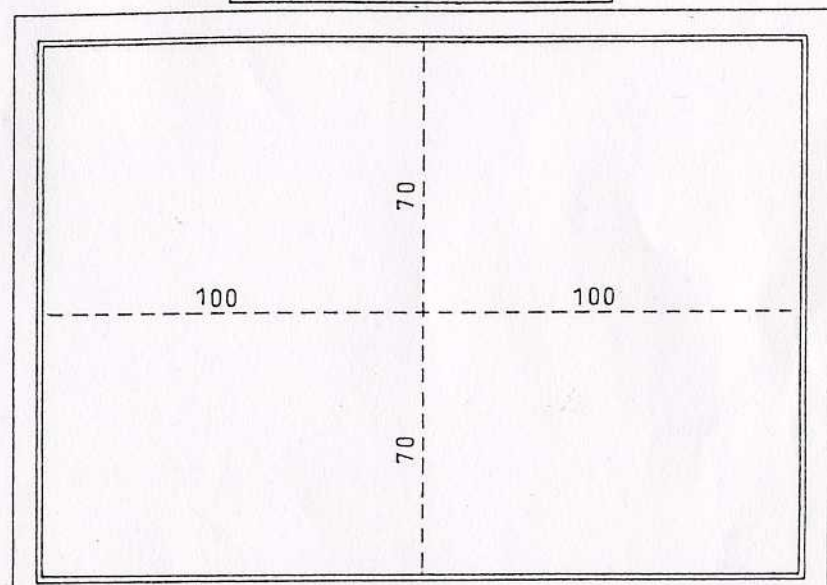

Impianto
n°

tubolare mm. 60

"standardo tipo D"

11.5

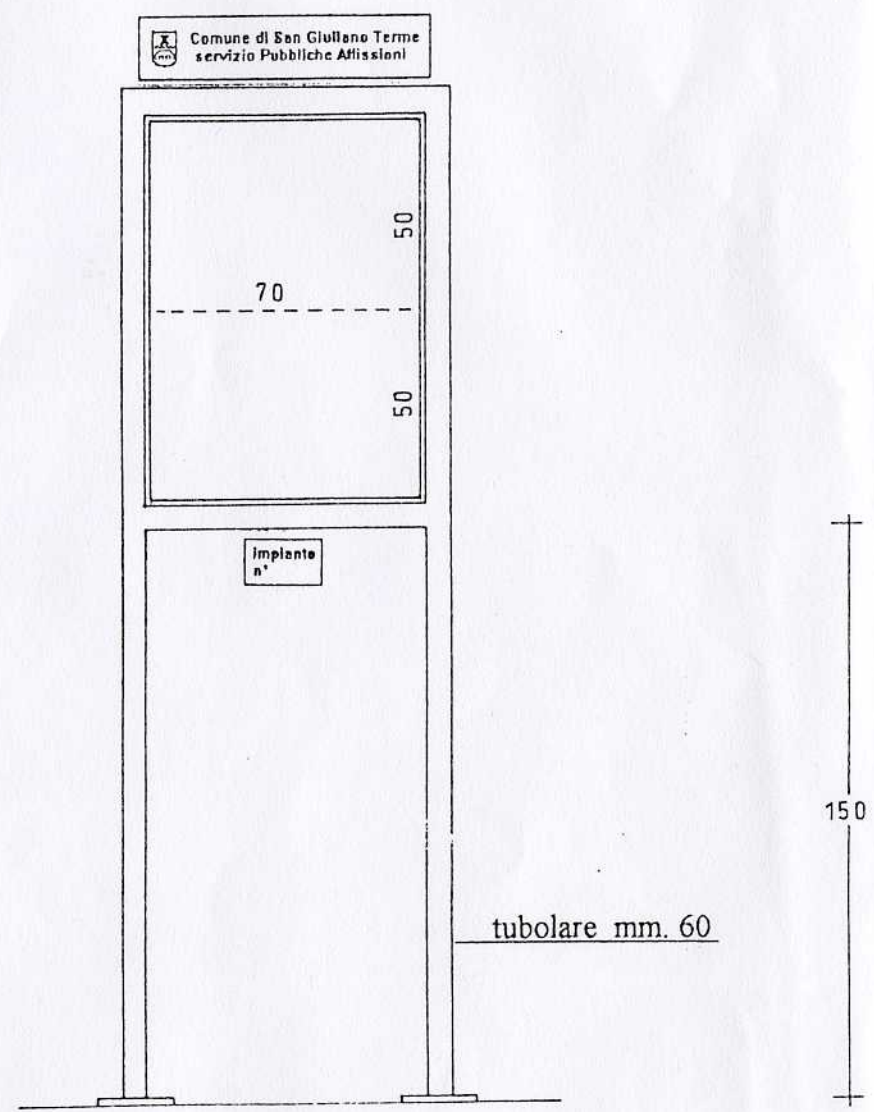

"standardo tipo F"

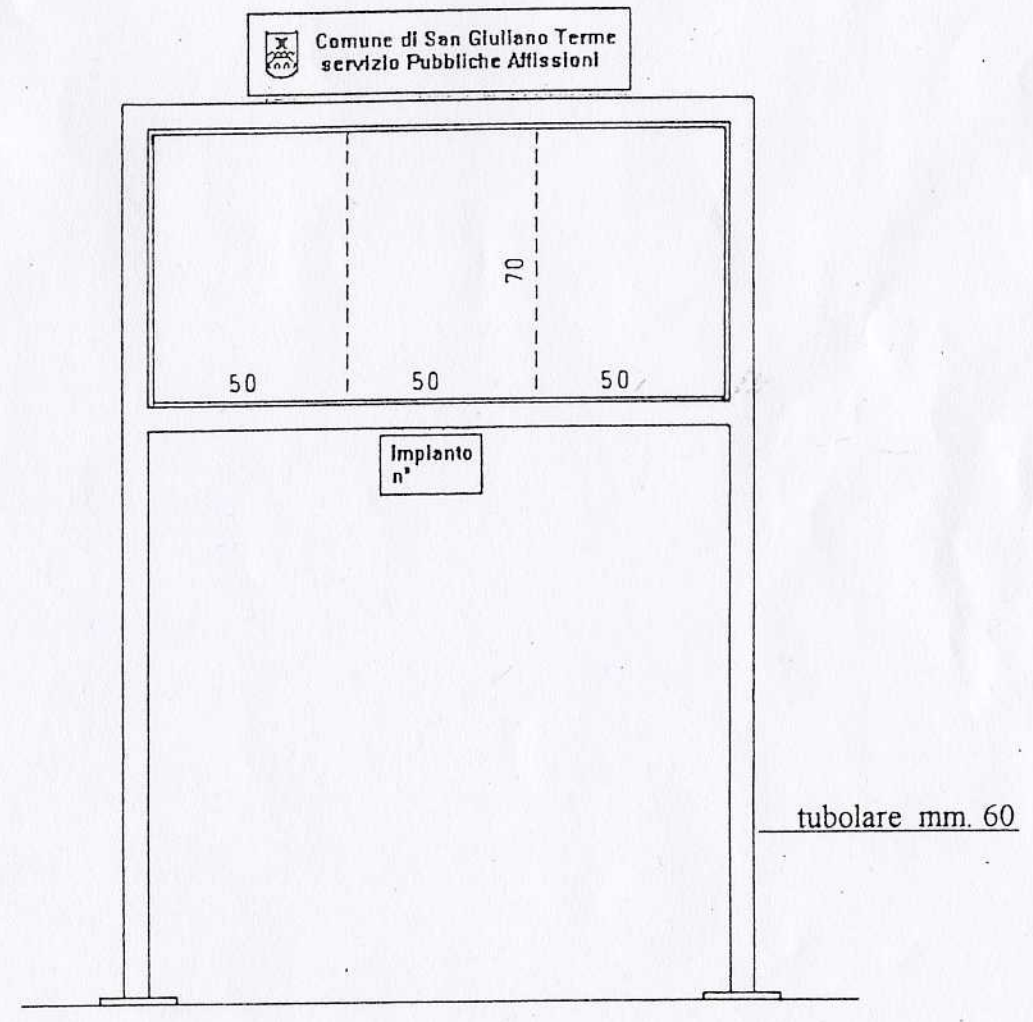

"standardo tipo E"

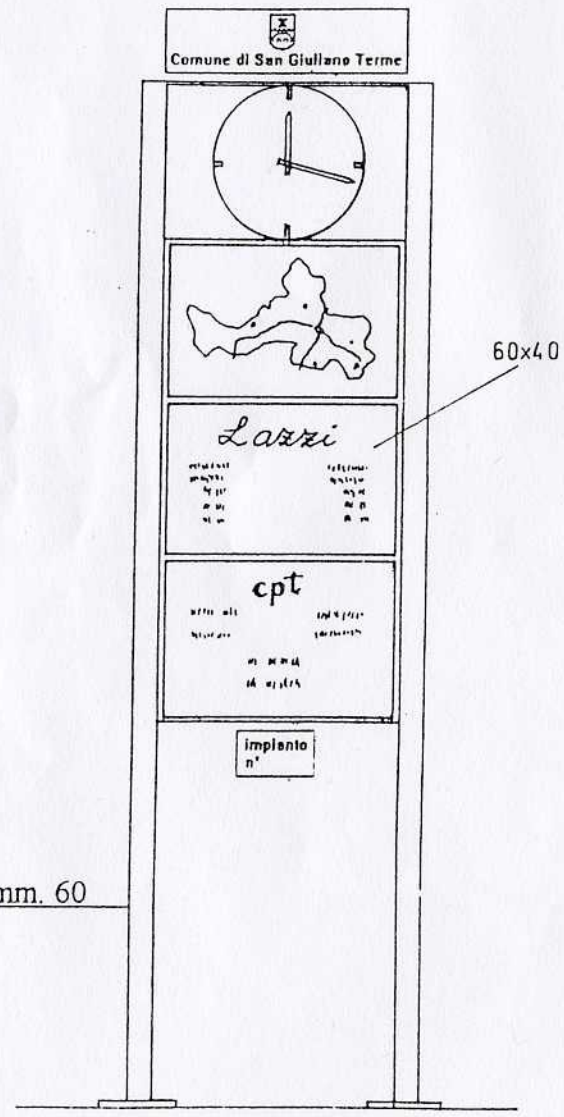

Paline
tipo A

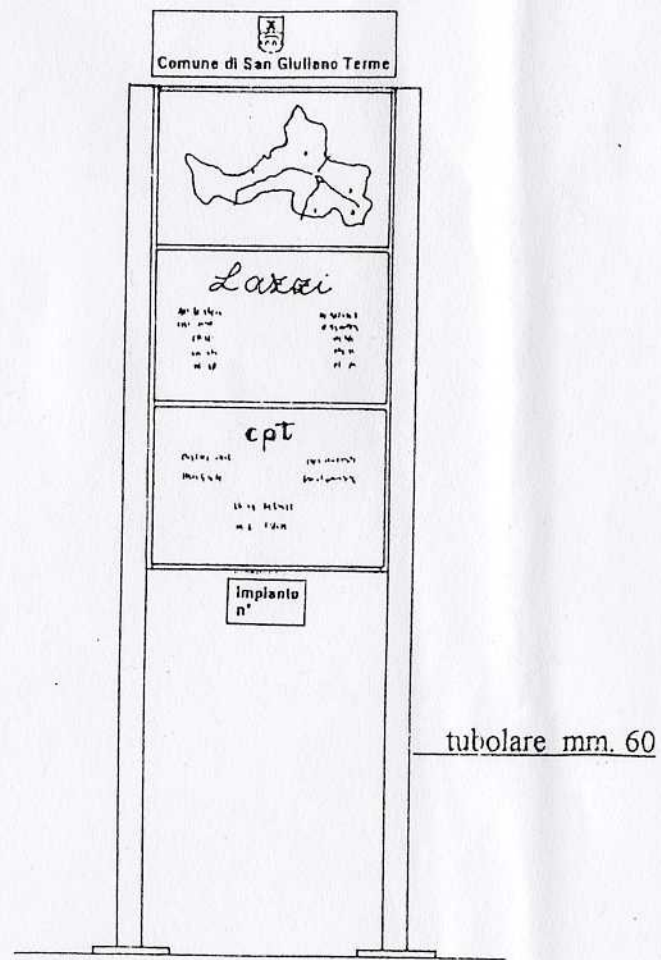

Paline
tipo B

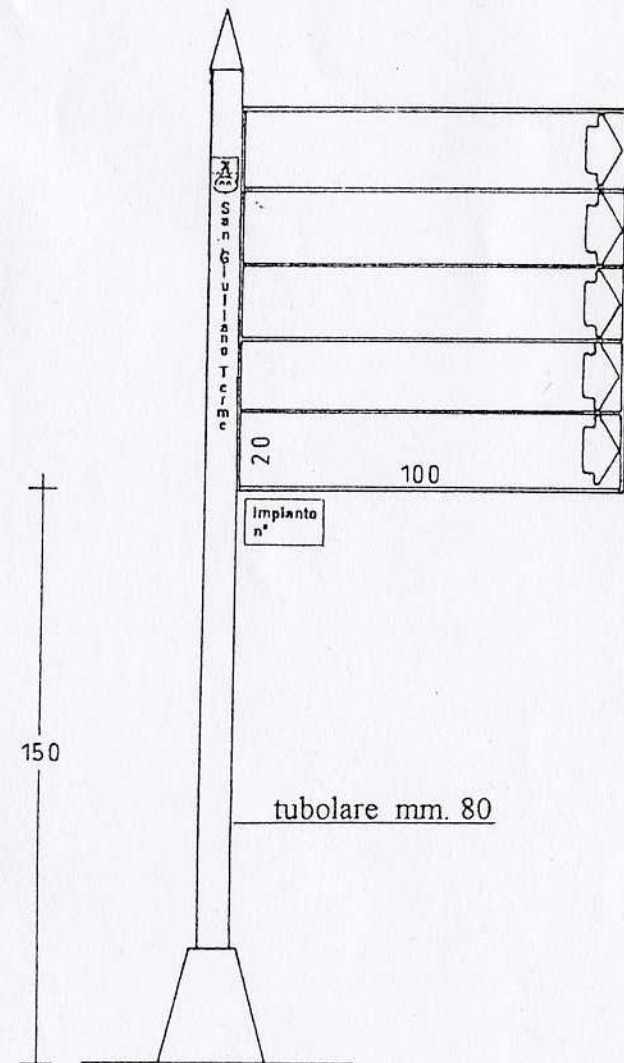

"Impianto per Frece indicatrici"

11.88



Comune di San Giuliano Terme

"la fontina"

zona commerciale - artigianale

impianto n°

tubolare mm. 100

150

200

100

220

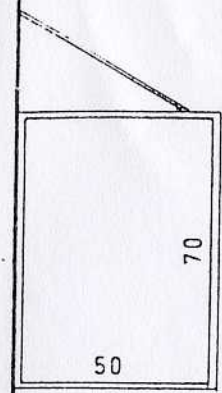

50

70

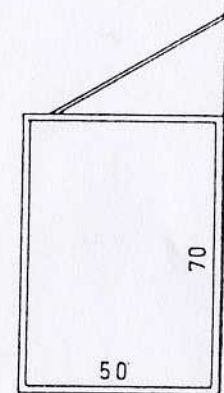

50

70

"Insegne a bandiera bifacciali" cm. (50 x 70)

"Pannelli ad illuminazione indiretta" ml. (1,00 x 2,00)